

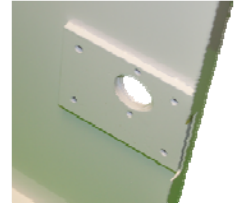

## Product Specifications

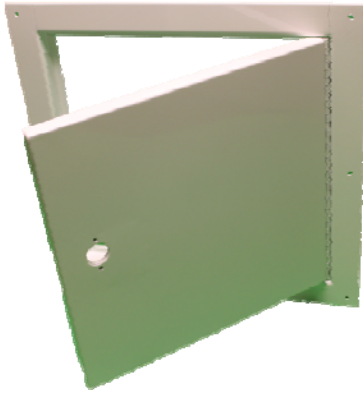

### 12" x 12" DetentionGRADE™ Ceiling Access Panel

Part No: 7935-1212

#### Specifications:

These Ceiling Access Panels are designed for access to the area above security ceilings in medium to maximum security areas. It is opened by the maintenance staff with a #12 Deadlock. The door panel is securely fastened to the frame and cannot be removed or misplaced.

#### Standard Features:

**Material:** Panel door is fabricated from 14ga Galvannealed steel sheet  
Frame is fabricated from 10ga HR steel sheet  
Hinge is fabricated from 16ga CR steel sheet with 3/16 n CR steel

**Cutout size:** 13" x 13"

**Overall size:** 17" x 17"

**Mtg Hardware:** 4 ea ¼-20 x ¾ Security Button Head Torx screws

**Lock:** Not included

**Finish:** Powder Coated White Full Gloss

#### Options Available:

**Paint:** Powder Coating in any standard architectural color

**Lock:** #12 Series Deadlock keyed per customer specifications